

PANDROL "E CLIP" MACHINE

"E" Clip Applications on both Wooden and Concrete Ties.

PCM-2P/U
PCM-2P/U1
PCM-2P



For "e" type PANDROL CLIPS

Rapid performance with a high degree of simplicity of use, requiring only one operator. Suitable to insert & extract "e" type Pandrol clips on both sides of the rail at the same time. A single operator can easily manage the machine.



POWERED by
HONDA



Braking system
PCM-2P-BRAKED meets the requirements of EN13977.



Easily adjustable to work both on wooden and concrete ties (long and short baseplate version) on several rail types.

PCM-2P/U



Typical application on which the PCM-2P/U is used: long baseplate (7.87 in.) on wooden ties.

PCM-2P/U & PCM-2P



Typical application on which the PCM-2P/U can be used: Short baseplate (2.76 in.) on concrete ties, Available upon request a special machine PCM-2P specific just this application.

PCM-2P/U1



Typical application for the PCM-2P/U1: special metro baseplate on concrete ties or basement.

PCM-2P/U... is equipped by a mechanical stop device guaranteeing that all the clips are fixed properly in the same way avoiding overdriving. The device is quickly removable so to allow the extraction of clips.



Insertion and extraction of the clip by means of the PCM-2P/U1

PANDROL "E CLIP" MACHINE

GENERAL FEATURES

- The PCM-2P/U... machine from Cembre is suitable for the insertion and extraction of "e" type pandrol clips used with 2.76 in. & 7.87 in. bases;
- The unit is immediately ready to use requiring no assembly or disassembly of accessories;
- Particularly suited to rail adjustment work, for instance on in-progress rail sections or track renewal, the PCM-2P/U... & PCM/2P machines also generally applicable in maintenance operations.
- Ballast on ties does not unduly affect the machine, as the clamp do not rest on them;
- The pump unit is the same as that used on PCM-2P/U, PCM-2P/U1, PCM-2P/FC and PCM-2P guaranteeing and high versatility in case of several applications.
- The pump unit is suited by a sturdy and powerful 4-stroke engine, Honda or equivalent, with noise levels according to CARB-EPA standards.
- Does not interfere with rail circuits due to the three insulated wheels;
- Compactness and easy transport makes the PCM-2P/U... machine a very reliable for the immediate use.
- Weight: Pump unit 108 lbs, Clamp unit 106 lbs , trolley unit 20 lbs , wheel bar 11 lbs
- The self-braking system is quick & easy to connect and intervenes automatically when the operator releases the handle of the machine.

ASSEMBLY SEQUENCE PCM-2P/U..

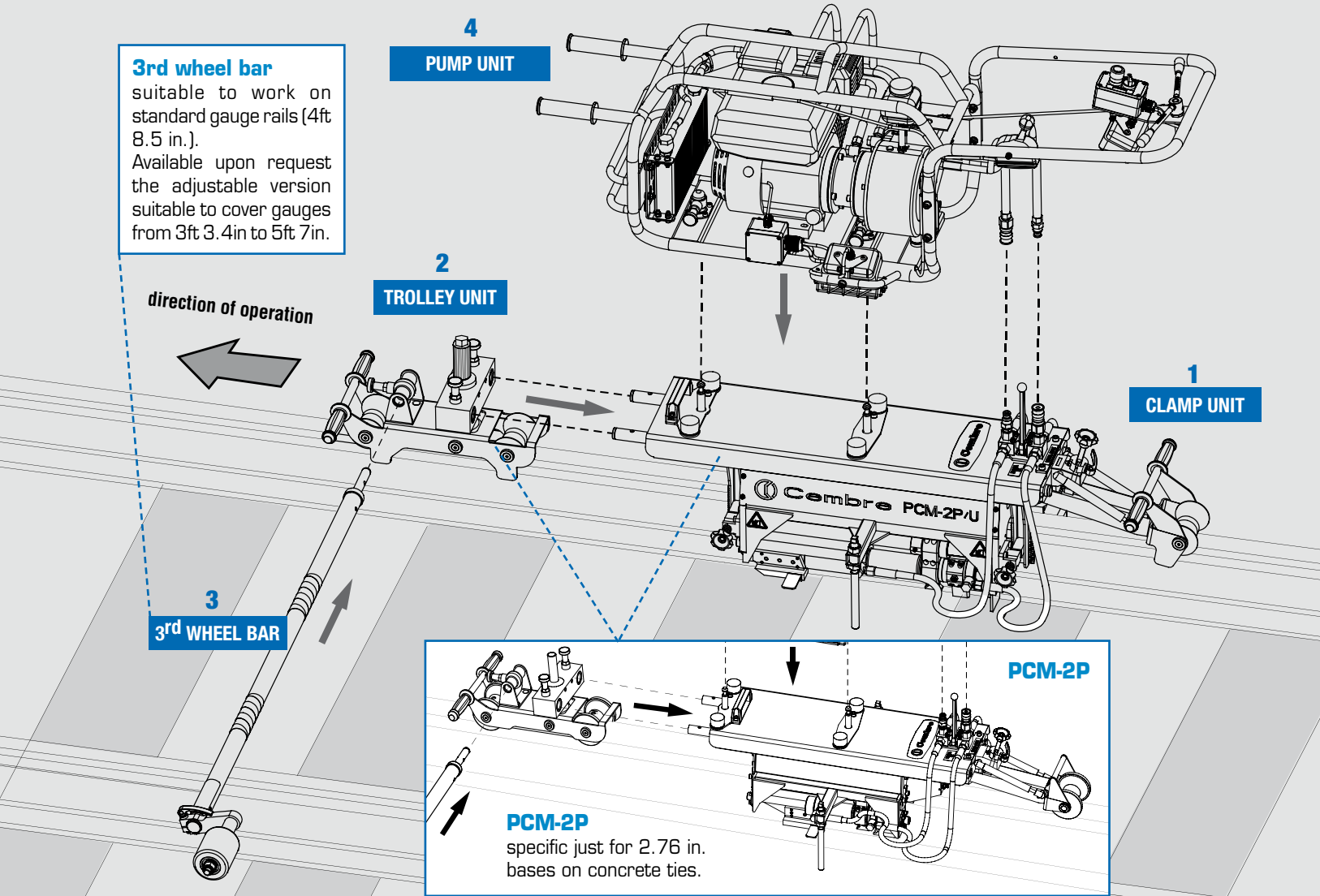

Easy assembly and transportation by two persons.

PANDROL "FAST CLIP" MACHINE

Homologation SNCF
IEM 04018

PCM-2P/FC For PANDROL "FAST CLIPS"

The PCM - 2P/FC machine from Cembre is suitable for the insertion and extraction of Pandrol "fast clips" used with all 4 ft 8.5 in. gauge standard rails mounted on monoblock or biblock concrete ties.



POWERED by
HONDA

Braking system
PCM-2P/FC-BRAKED meets the requirements of EN13977.

This PCM-2P/FC version is also equipped with a rapid and easy to use fine adjustment system allowing the 'fast clip' to be positioned in either the pre-assembled parked position, the fully inserted/removed position or the insulator change position, as shown in the figs alongside.



GENERAL FEATURES

- The pump unit is the same as that used on the Pandrol "e clip" machine (see page 30) and consequently owners of the PCM-2P need purchase only the PCM-2P/FC clamp unit.
- Easy disassembly allowing operators to work safely on uneven ground.
- The unit is immediately ready to use requiring no assembly or disassembly of accessories.
- Rapid performance with a high degree of simplicity of use requiring only one operator.
- Simultaneous insertion or extraction of two clips by two independent clamps.
- "Fast clips" located on one side of the rail may be inserted or extracted when there are no clips on the opposite side.
- Possible to work with only one of the clamps, either for insertion or extraction, to operate if necessary on only one side of the rail.
- The pump unit is the same as that used on the "e" clip machine, incorporating a sturdy and powerful 4-cycle engine, Honda or equivalent, with noise levels according to CARB-EPA standards.
- Does not interfere with rail circuits due to the three insulated wheels and is also equipped with an appropriate mechanical joint to allow running without interference on the rail to reach the working area.
- Equipped with spot lights oriented to the working areas.
- Weight: Pump unit 108 lbs, Clamp unit 145 lbs, Trolley unit 20 lbs, 3rd wheel bar 11 lbs.
- The self-braking system is quick & easy to connect and intervenes automatically when the operator releases the handle of the machine.



Extraction and insertion of Pandrol "fast clips".

PANDROL "FAST CLIP" MACHINE

ASSEMBLY SEQUENCE PCM-2P/FC

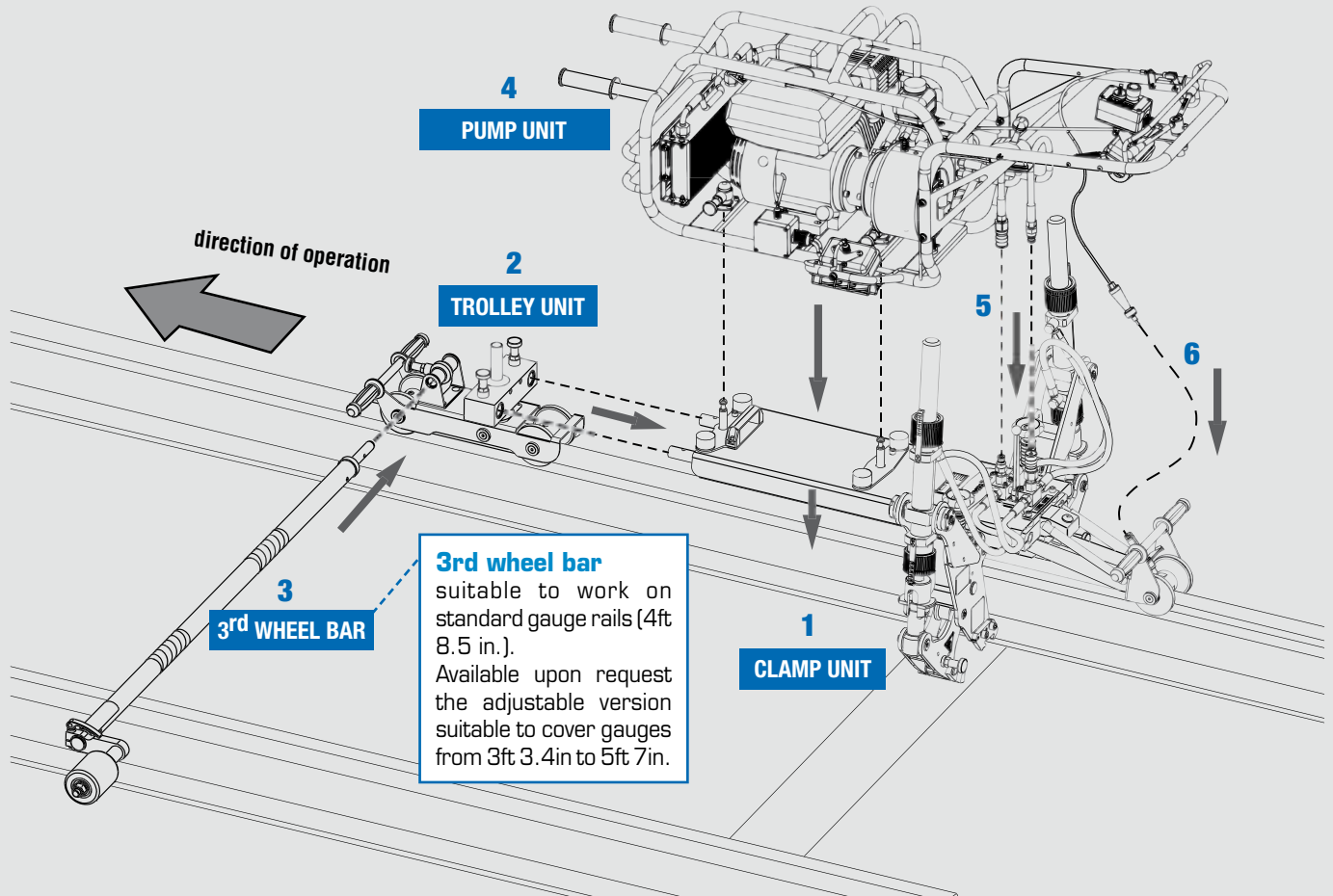

OPTIONAL ACCESSORIES FOR PANDROL CLIP MACHINES

TARPCOVER 019-PCM

Robust UV resistant cover for PCM machines.
Temperature range: -40°C to +70°C.



MPC 6

Manometer for checking the operation of the maximum
pressure value in the hydraulic circuit.

